

Assembly Instructions

Item No.: 8726

Parts and hardware

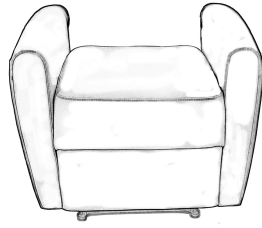

1 piece of chair base

B

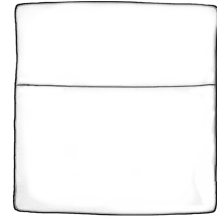

1 piece of backrest

Assembly System

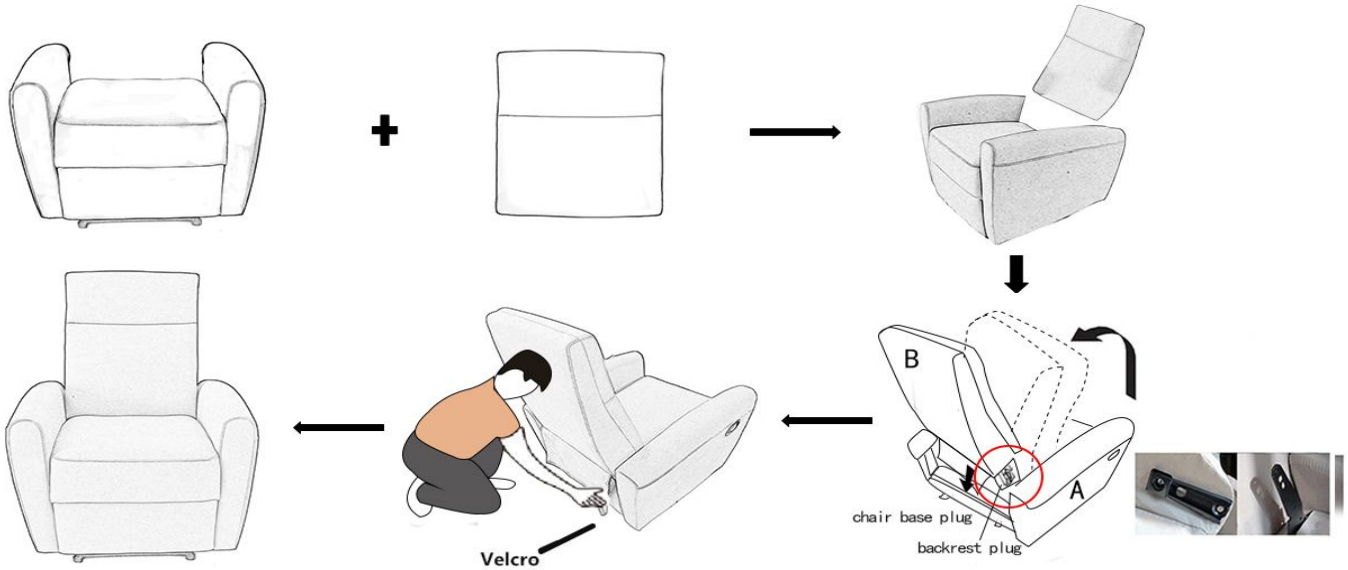

1. Take out the chair backrest(A) from chair base(B). Place the chair base(B) face down on a clean, non-marring surface.

2. Connect the backrest plug(B) to the chair base plug(A). Make sure all parts are connected and securely locked into position.

Disassembly Instruction

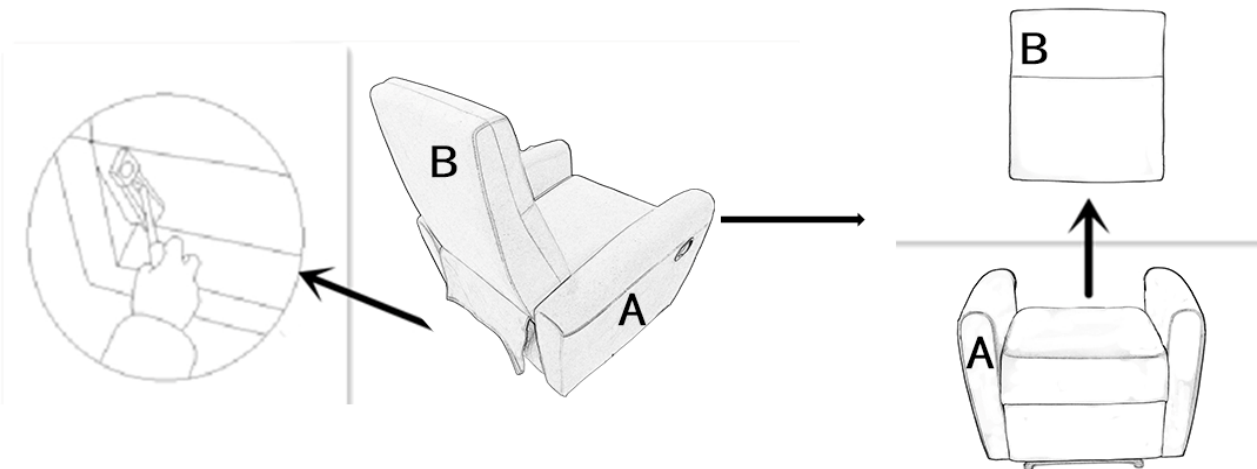

- Open the flap on the backrest(B), use a screwdriver pressing outward on the metal ear on the preattached metal bracket on one side of the chair base(A).
- Keep the chair base(A) in place, pull the backrest(B) upward at the same time, repeat the same step for another side.

Warning

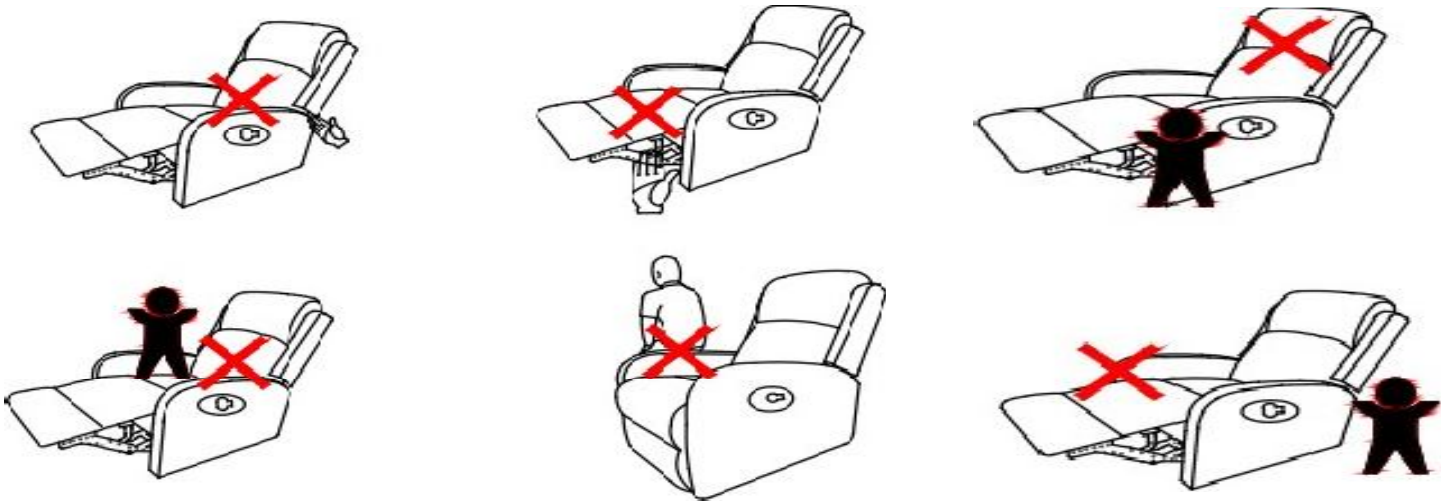

- Do not allow children to play on the recliner.
- Always leave the recliner in an upright and closed position after use.
- Keep hands and feet clear of the footrest mechanism and any gaps.
- Don't sit on the armrests of the recliner.

User Instructions

To get into the recline position:

- Sit in and pull the lever on the outside of right armrest.
- Use your body weight and push backwards into the seat into a fully reclined position.



Enjoy your most comfortable time



110°



120°



135°



150°



160°

To move the chair back into the upright :

- Tilt your body weight slightly forward and upwards.
- The backrest will come up to an upright position.
- Use your feet to push the footrest down.
- The chair will automatically lock when it is in the fully upright position.
- Where necessary, use your arms help lift/push yourself out of the seat

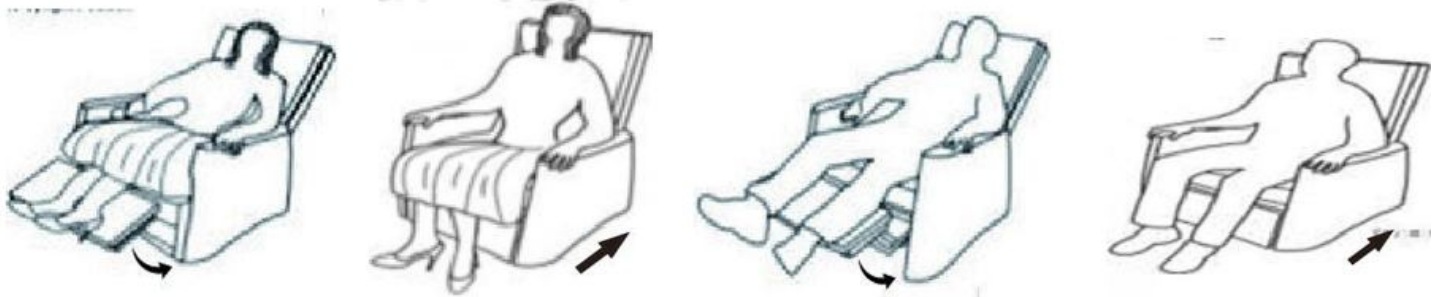

Care & Maintenance

	<ul style="list-style-type: none"> ● Do not put hot items directly on furniture surface
	<ul style="list-style-type: none"> ● Do not clean furniture with harsh cleansers or polish
	<ul style="list-style-type: none"> ● Do not place furniture under direct sunlight
	<ul style="list-style-type: none"> ● Do not place furniture near heating or cooling vents
	<ul style="list-style-type: none"> ● Do not write on furniture without a padded barrier to protect the surface
	<ul style="list-style-type: none"> ● For indoor use only
	<ul style="list-style-type: none"> ● For residential use only
	<ul style="list-style-type: none"> ● Stains may be removed with mild soap solution and damp cloth
	<ul style="list-style-type: none"> ● Children should not climb or jump on the furniture
	<ul style="list-style-type: none"> ● Dust and pick-up spills using a clean, non-colored, lint-free cloth